

190SL CATALOG

Web Site: www.kkmfg.com
e-mail: sales@kkmfg.com

Catalogs are also available online.

We carry rust repair panels and rubber for the following models:

108, 110, 111, 114, 115, 123, as well as extensive inventory for

107 and 113

K&K MFG, INC.

951 NINE MILE ROAD SPARTA, MI 49345 (616) 784 4286 FAX# (616) 784 4296 TOLL FREE ORDER # 1 800 876 4286

WELCOME TO K&K MFG. INC.

We are a major manufacturer of rust repair panels for Mercedes Benz convertibles and sedans from the mid 1950s through the 70s.

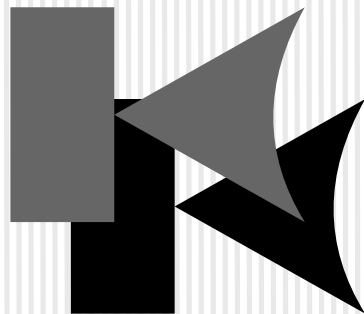
We also stock a full compliment of parts for the convertibles

Extensive inventory from top to bottom and front to back including used parts

Shipping available through UPS, mail, truck service, and international air and ocean

Payment accepted by cash, certified check, Visa, Discover, Mastercard, and American Express

Prices subject to change without notice



K&K MFG, INC.

951 NINE MILE ROAD SPARTA, MI 49345 (616) 784 4286 FAX# (616) 784 4296 TOLL FREE ORDER # 1 800 876 4286

We appreciate the opportunity to send this catalog to you.

We welcome any comments regarding this catalog as it is quite unique in format, due to us making a great effort to make it easy to read and follow. We stock more parts than are illustrated in these pages and many used parts as well. Don't be afraid to ask. Our staff would be more than happy to provide a quote on any other needs for your cars.

Thank you for your interest.

- Tim Kidder

Keep updated with price changes and new offers at: www.kkmfg.com
e-mail: sales@kkmfg.com

GENERAL INFORMATION

ABOUT K&K MANUFACTURING

K&K Manufacturing was started in August of 1982 in the home and garage of Tim & Pat Kidder. We took over making parts for Barry Stuart who started making floor parts for the 190SL. My wife was 7 months pregnant with our second child when I quit my job to go full time into this business. My 3 year old son had to wear safety glasses to watch TV because of my hand cutting steel parts in our living room. We grew from our home into a 12,000 sq ft. building on 11 industrial acres by 1986.

We strongly believe that God has sustained us through these times and blessed this business despite our shortcomings. We believe that God owns everything including K&K Mfg. Inc. and we are privileged to run it. We give honor and glory to God for all He has done for us through the years.

We started making 190SL parts and around 1988 started making parts for the 113 chassis cars, the 230-280SLs, and now the 107 chassis cars, 350-450SLs. We started with rust repair parts and branched into most others, as you will see when you browse through the catalog. We are the world's only manufacturer of many of these parts. Contained in our facility is a pattern shop, tool making, CNC mill, and 6 presses from 50 to 300 tons.

You will receive personalized service from Tim, Cheryl, or Jeff. In addition to manufacturing parts we have also restored over 40 cars, and our employee Rob has done over 120 restorations. This has provided us with a good working knowledge of what it takes. We are constantly striving to be the leader in production parts for the Mercedes Benz coupe and convertible models from the 50's through the 70's. Many of the parts also fit the sedans.

We encourage any suggestions and comments about the catalog or future items to reproduce. Thanks for your interest in our company and may God bless you.

Tim Kidder, owner

WARRANTY:

All parts supplied are of the highest quality possible for a fair price. Being the manufacturer of many of these and having used them ourselves on over 40 restorations we can guarantee your satisfaction on all we make. All other products are subject to the manufacturer's warranties. Warranty of those items is limited to replacement of the defective part. All other liability is waived.

ORDERING INFORMATION

To speed processing your order, please have the year, model, and serial number of your car ready. If you have been issued a customer number, please give us that as well.

Our prices are competitive and included in this catalog but are subject to change without notice as many are tied to exchange rates of the dollar and to fluctuating steel prices.

We stock the highest quality parts possible for each model and manufacture the same.

PAYMENT METHODS:

We accept Visa, Mastercard, Discover, and American Express. CODs are available to business addresses only with payment by certified check or money order. We do not accept personal or business checks. Out of stock parts will only be charged once shipped.

SHIPPING:

We strive to keep our shipping costs down. We have a daily UPS pick-up and we also use the postal service. Truck shipments are to business addresses only. We welcome international orders and ship through the postal service or through a variety of international shipping services. Packaging and insurance charges are extra and will be added to the order based upon the size of the shipment. Faster shipping methods are available through UPS, mail, or other air freight companies we use.

RETURNS:

We accept returns of new (good conditioned) items purchased within 60 days. There will be a 15% restocking fee on returns unless the item was shipped in error. Unfortunately, we cannot accept returns of electrical parts, convertible tops, leather or vinyl interior, carpet, or specially ordered items.

CORE CHARGES:

Core charges are billed at shipping with applicable parts. We will refund the core charge when we receive your rebuildable core. Call for applicable core fees.

TECHNICAL DATA & TIPS

ORIGINAL INVOICES

The original factory invoice is available for your car. You can write to:
 MBNA
 One Mercedes Drive
 Montvale, NJ 07645
 Attn: Public Relations Dept.

Send a photo-copy of your title to prove ownership and to give them the serial number. Make sure the number matches your car. It takes about six weeks. If MBNA fails to get it, write to:

Daimler-Benz Archives
 7000 Stuttgart 60
 Germany

Remember, this will take some weeks.

PRODUCTION DATA & CHASSIS NUMBERS

Your 190SL may not be titled the same year it was built. This happened frequently. The changes that were made during the years of manufacture were many and were done by chassis number designation, not by year. It is therefore important to have the serial number of your car and even some of the components when ordering parts. On the next page you will see the locations of where to find the serial numbers for the chassis, engine, front suspension, and rear axle. Following are production numbers and chassis numbers for each year:

YEAR	PRODUCTION	CHASSIS NUMBERS
1955	1,727	55.00001-55.01727
1956	4,032	65.00001-65.04032
1957	3,332	75.00001-75-3332
1958	2,722	85.00001-85-02768
1959	3,949	95.00001-95.02398
1959		10.014211-10.015762
1960	3,977	10.015763-10.019739
1961	3,792	10.019740-10.23531
1962	2,246	10.023532-10.025777
1963	104	10.025778-10.025881

Up To July-August
 After July-August

PAINT CODES/COLORS

DB-40
 BLACK

DB-50
 WHITE

DB-158
 WHITE GRAY

DB-166
 BLUE GRAY

DB-180
 SILVER METALIC

DB-190
 GRAPHITE GRAY

DB-334
 LIGHT BLUE

DB-534
 FIRE ENGINE RED

DB-543
 STRAWBERRY RED MET.

DB-608
 IVORY

DB-213
 PEARL GREEN

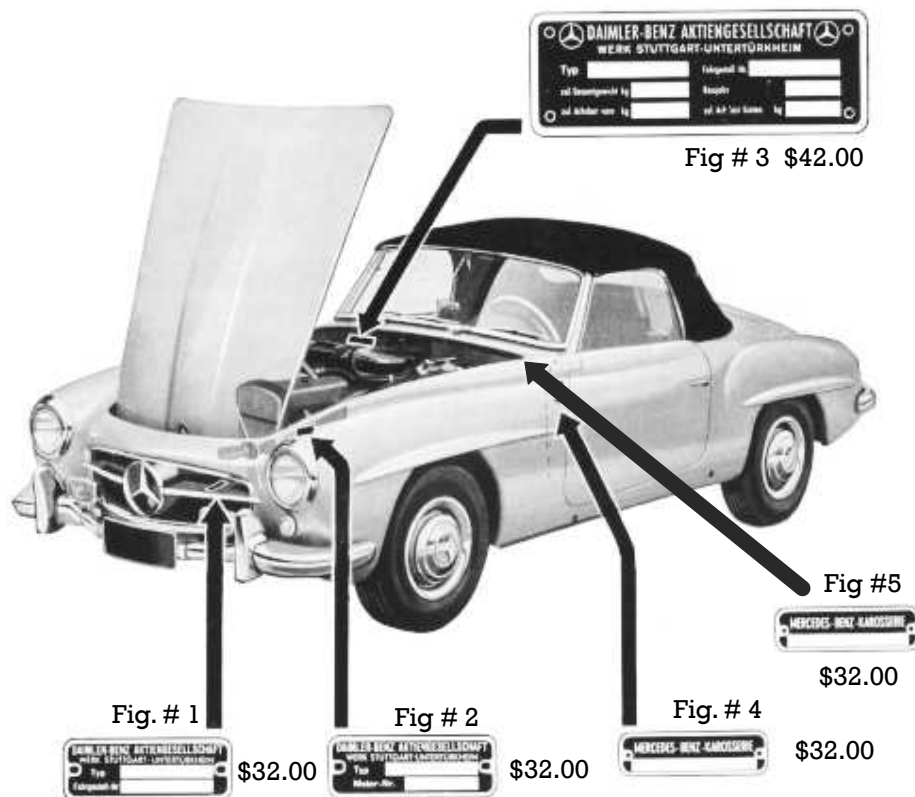
DB-380
 DOLPHIN BLUE

Floors and Frame Bottom

DB-169
 DARK GREY

Paint chip colors are
 available on our web site:
www.kkmfg.com

SERIAL NUMBER LOCATIONS



1. To order engine parts, give the serial # on Fig #2 located on the side of the engine block, at the left rear side just below the cylinder head.
2. To order chassis and body parts, give the serial # located on Figs #1 and #3. #1 is located on top of the right frame rail and # 3 is on the firewall on the right side above the battery.
3. Fig #4 will have a serial number that should match either the tag on the frame (Fig #1) or the tag on the firewall (Fig #3) or the stamped # left firewall.
4. Shown is a tag on the firewall near the wiper motor that designates the color of car and the type of paint that was used. E.g. DB-50 Fig#5.

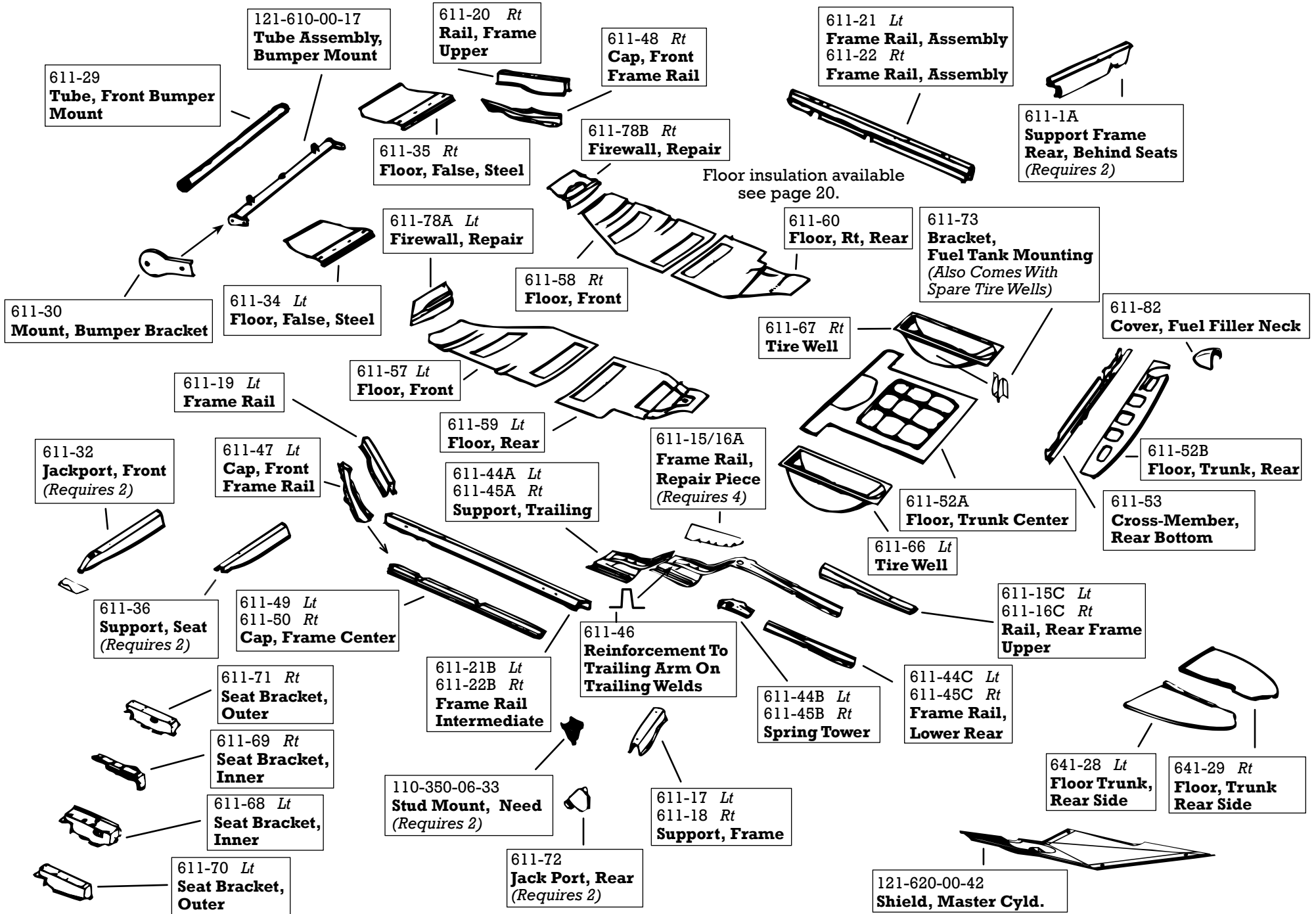
FOR YOUR RECORDS, FILL OUT THE FOLLOWING

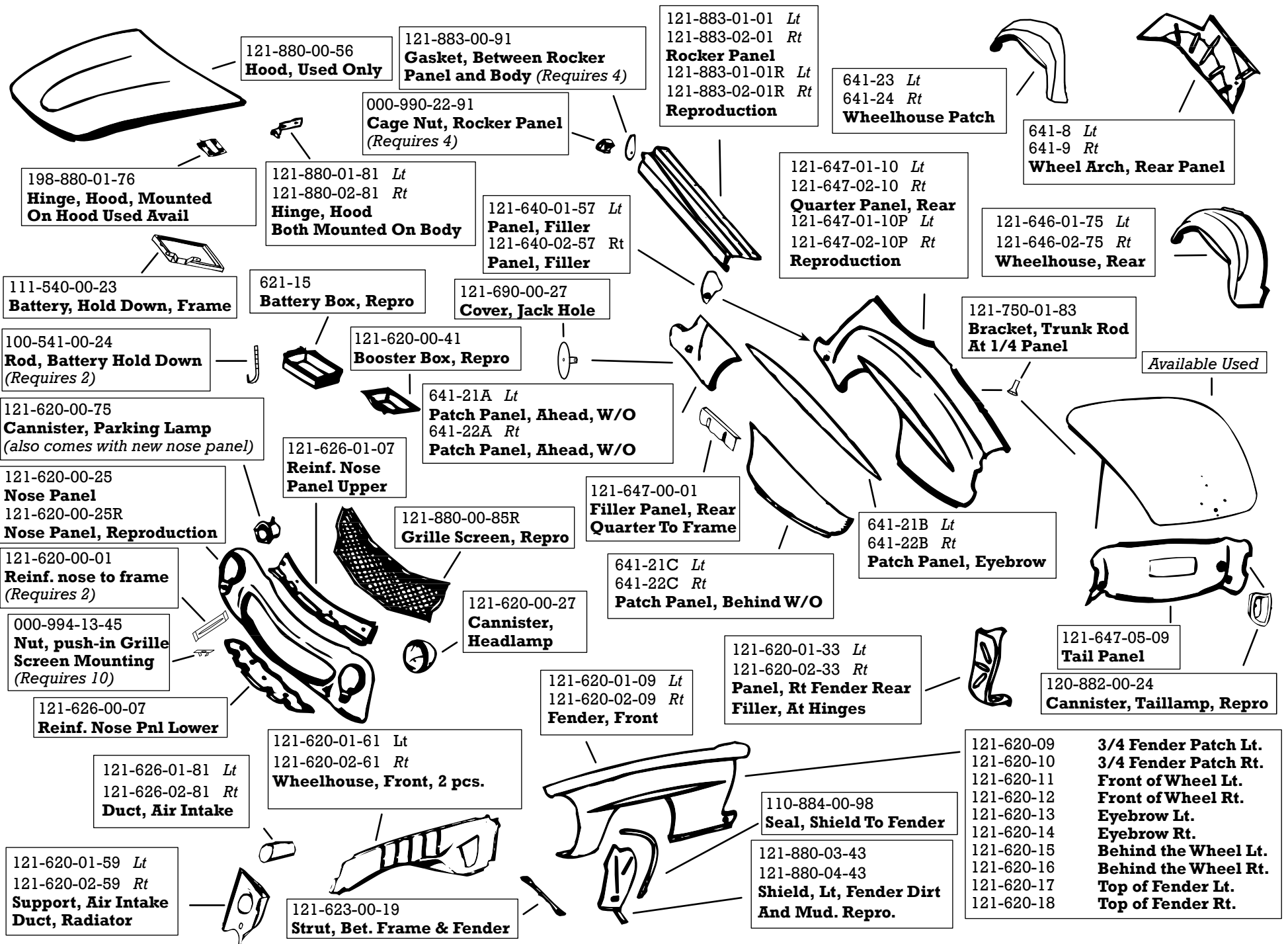
Engine Number _____
 Chassis Number _____
 Paint Code Number _____
 Transmission Number _____
 Front Axle Number _____
 Rear Axle Number _____
 Steering Box Number _____
 Ignition Distributor Number _____

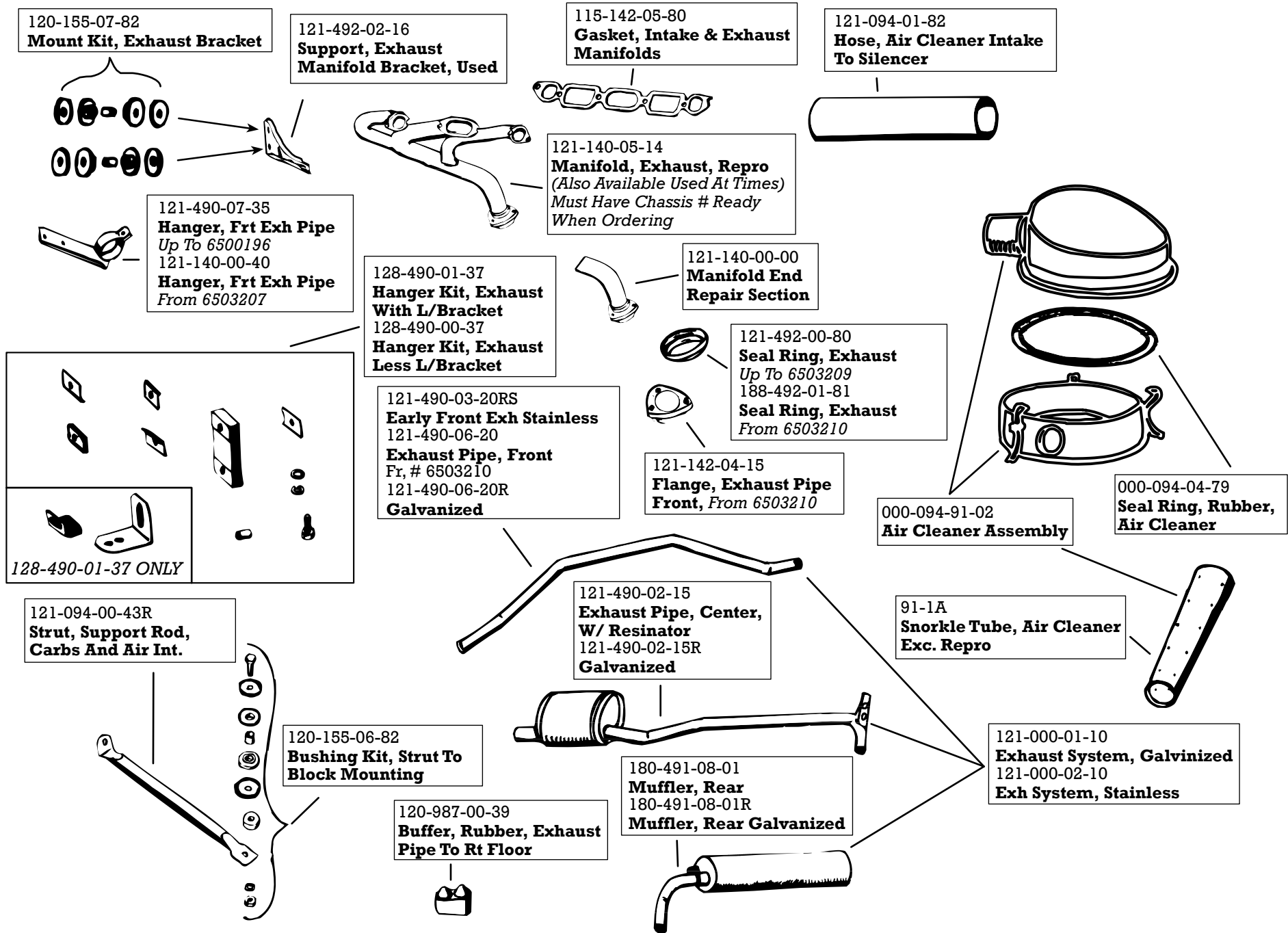


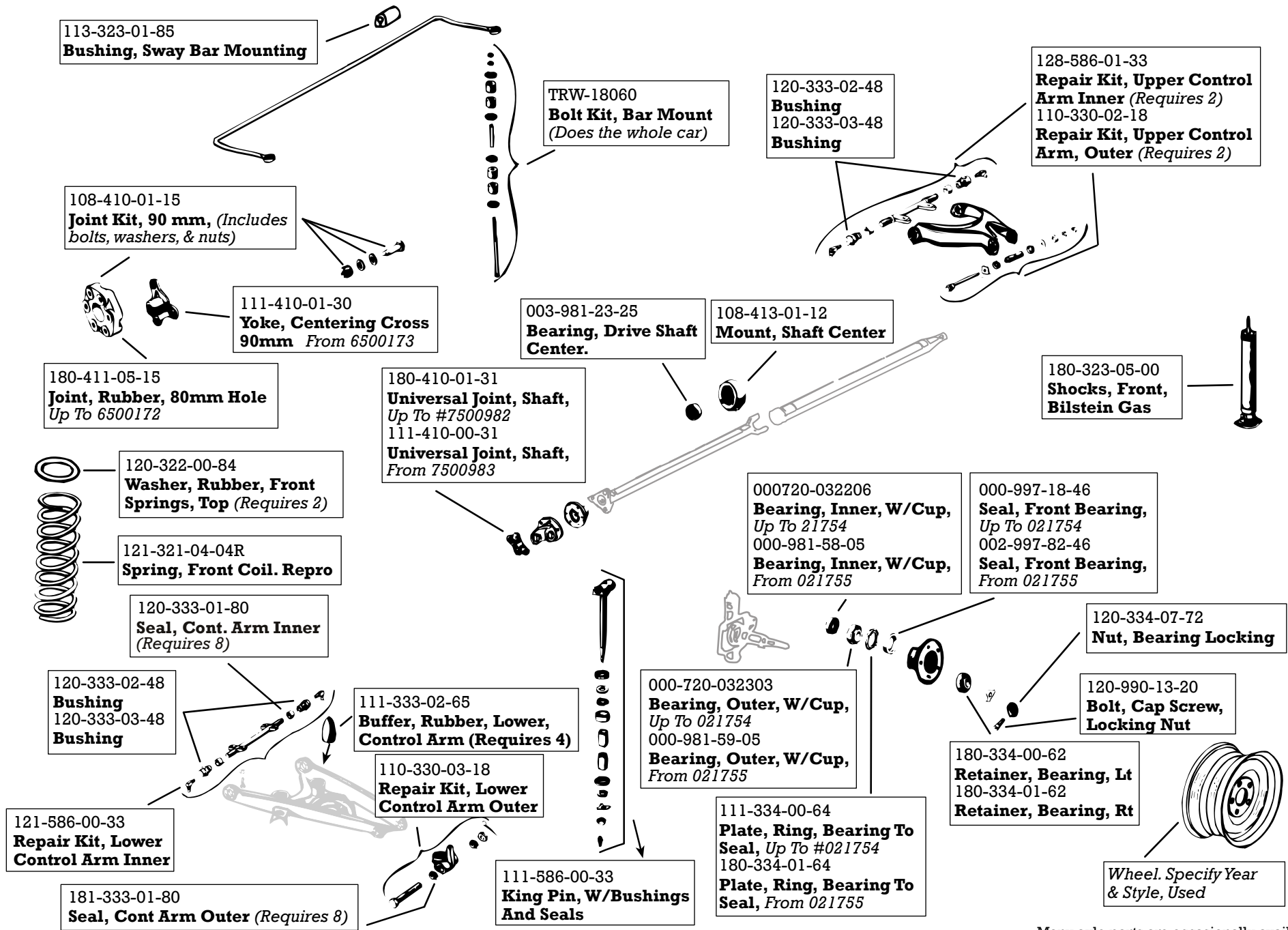
TABLE OF CONTENTS

PAGE 01	FRAME & FLOORS
PAGE 02	BODY PANELS
PAGE 03	EXHAUST & AIR CLEANER
PAGE 04	FRONT SUSPENSION
PAGE 05	STEERING & SUBFRAME
PAGE 06	REAR SUSPENSION & AXLE
PAGE 07	BRAKES 1
PAGE 08	BRAKES 2
PAGE 09	CLUTCH & TRANSMISSION
PAGE 10	ELECTRICAL & WIRING
PAGE 11	HEATING & COOLING
PAGE 12	GAUGES & SWITCHES
PAGE 13	UPPER ENGINE PARTS
PAGE 14	LOWER ENGINE PARTS
PAGE 15	FUEL SYSTEM
PAGE 16	CHROME & EMBLEMS
PAGE 17	SEALS & GASKETS
PAGE 18	DOORS & GLASS
PAGE 19	LIGHTING
PAGE 20	CARPET & ACCESSORIES
PAGE 21	TOPS & UPHOLESTRY
PAGE 22	GROMMET SET

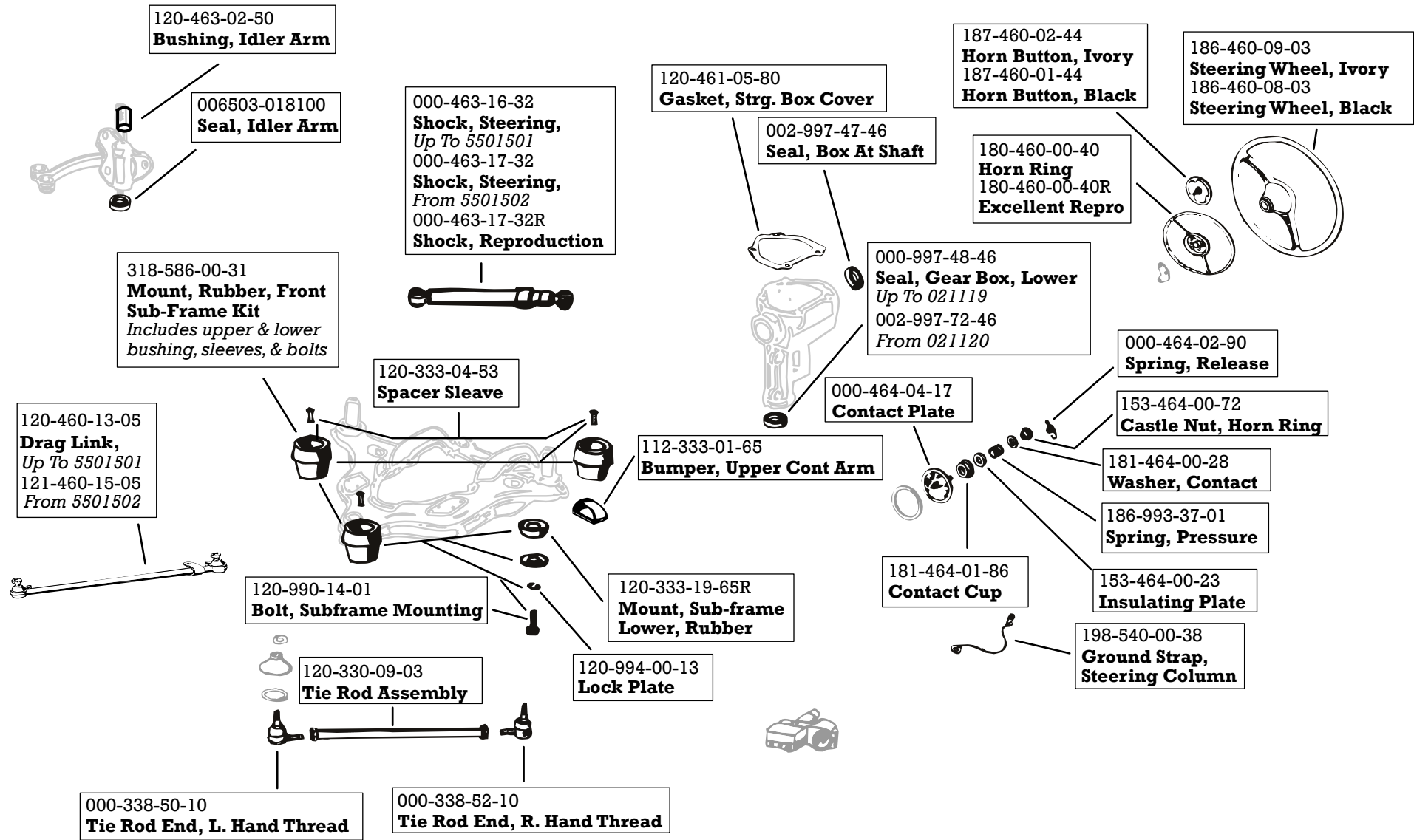


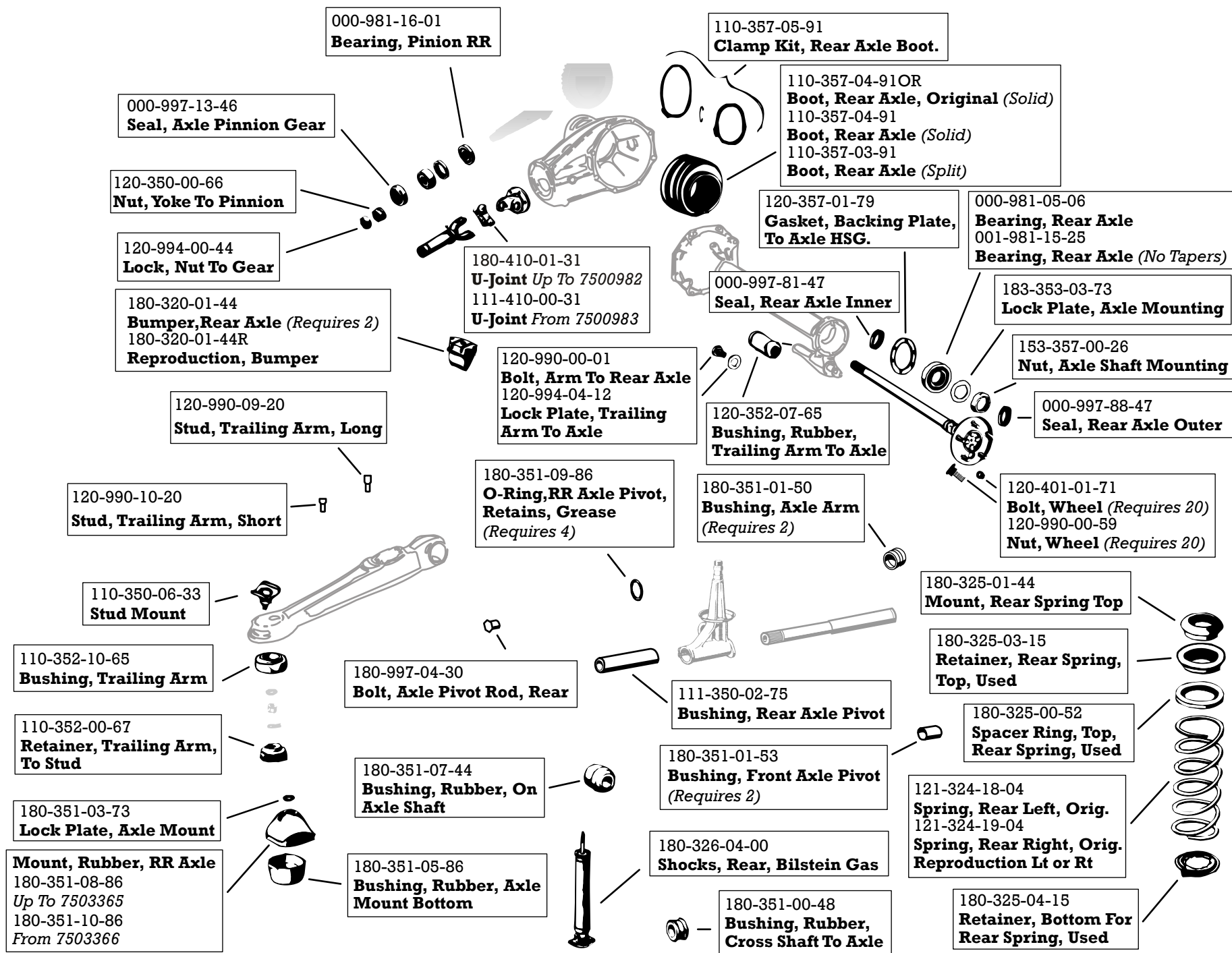


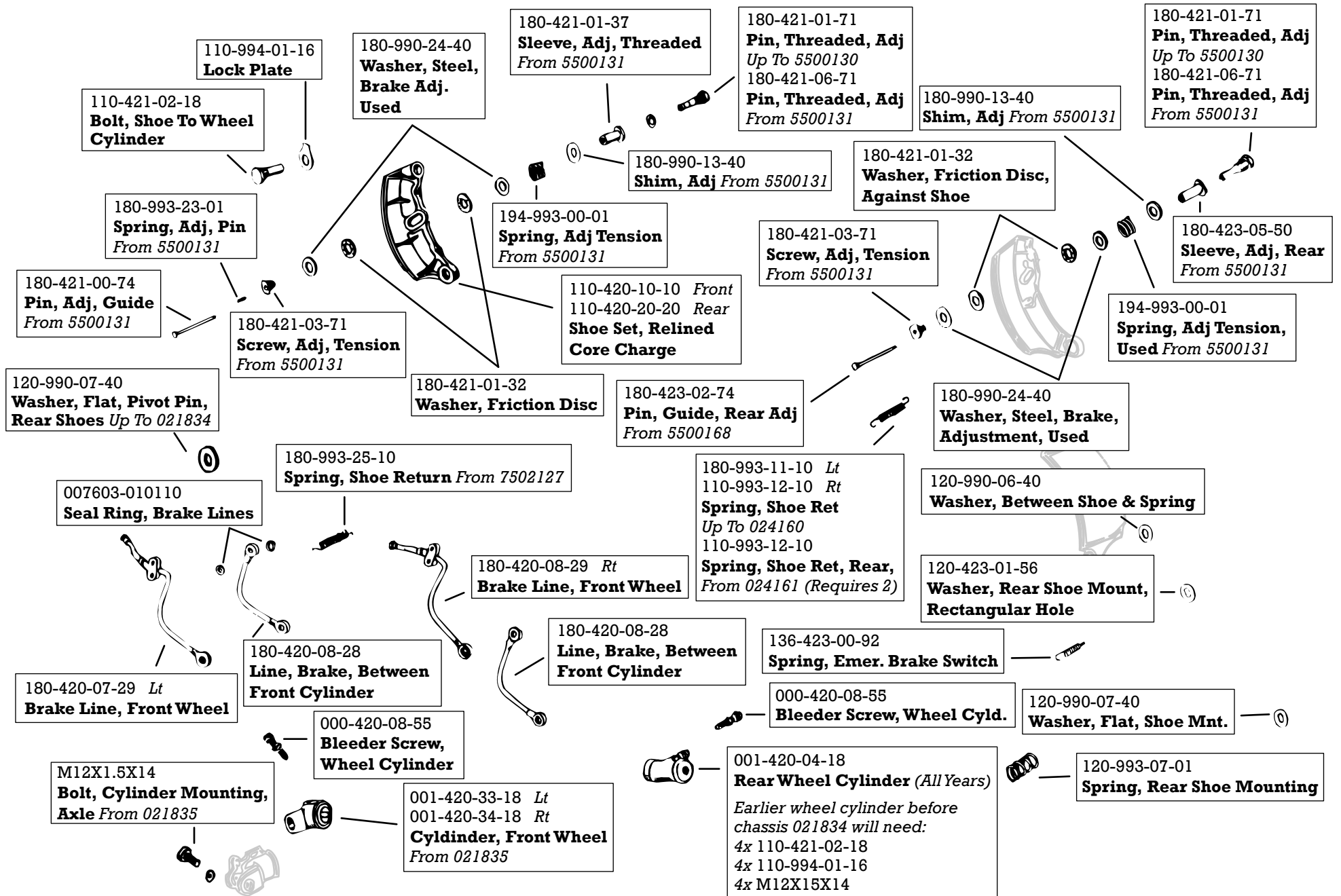


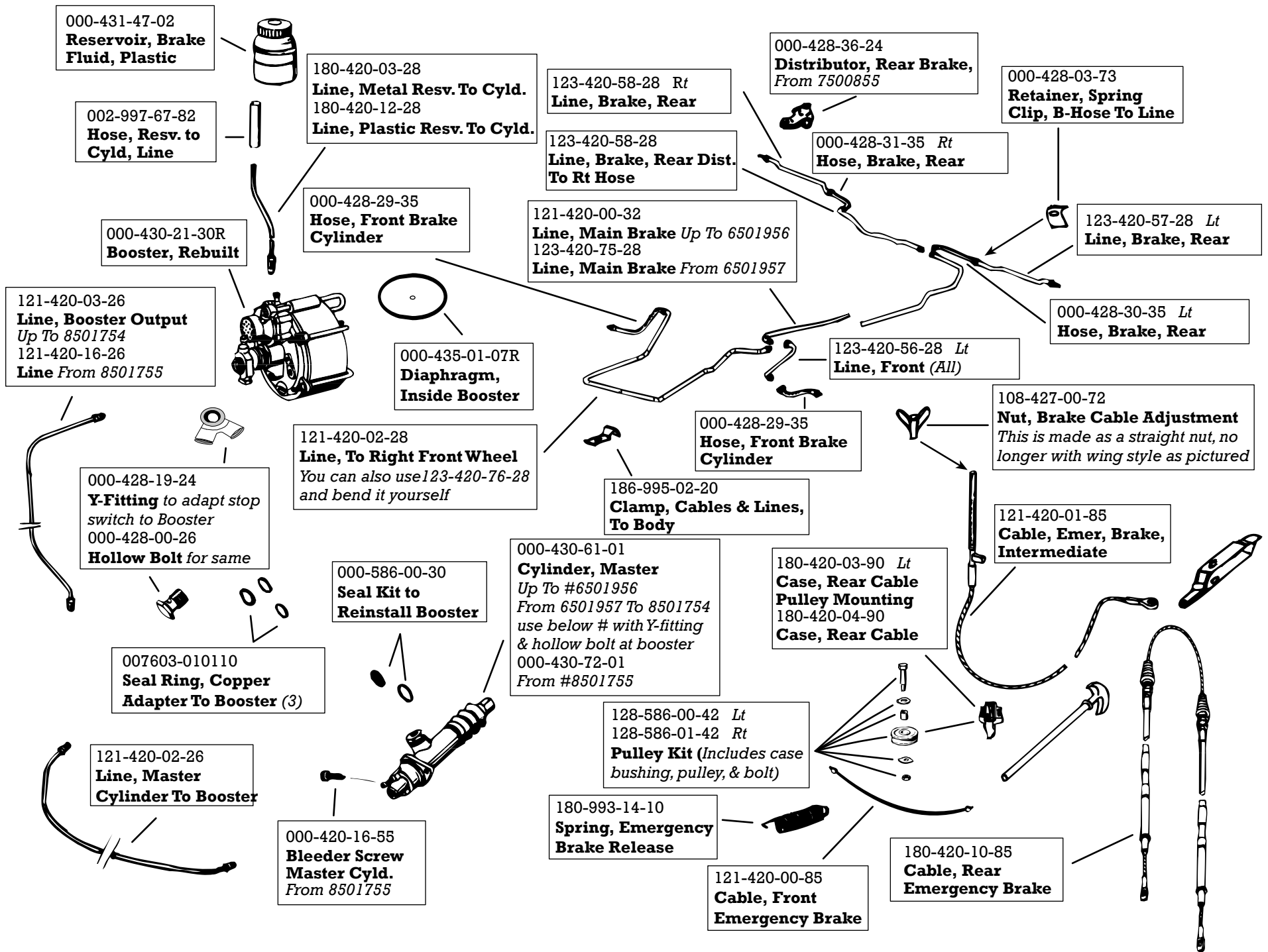


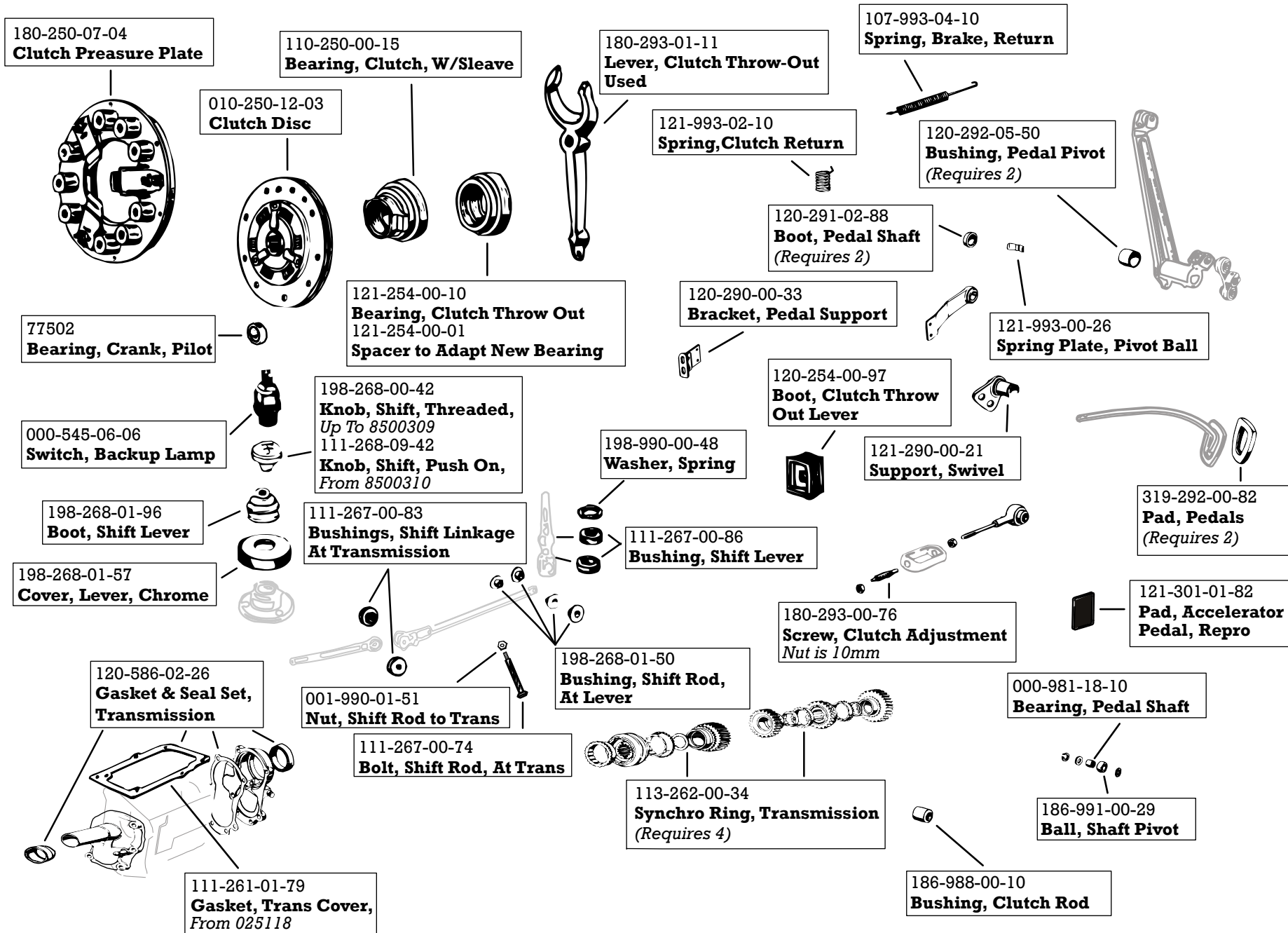
Many axle parts are occasionally available used. Please call for availability

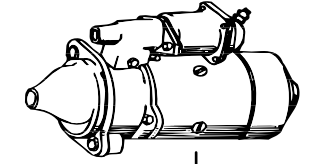
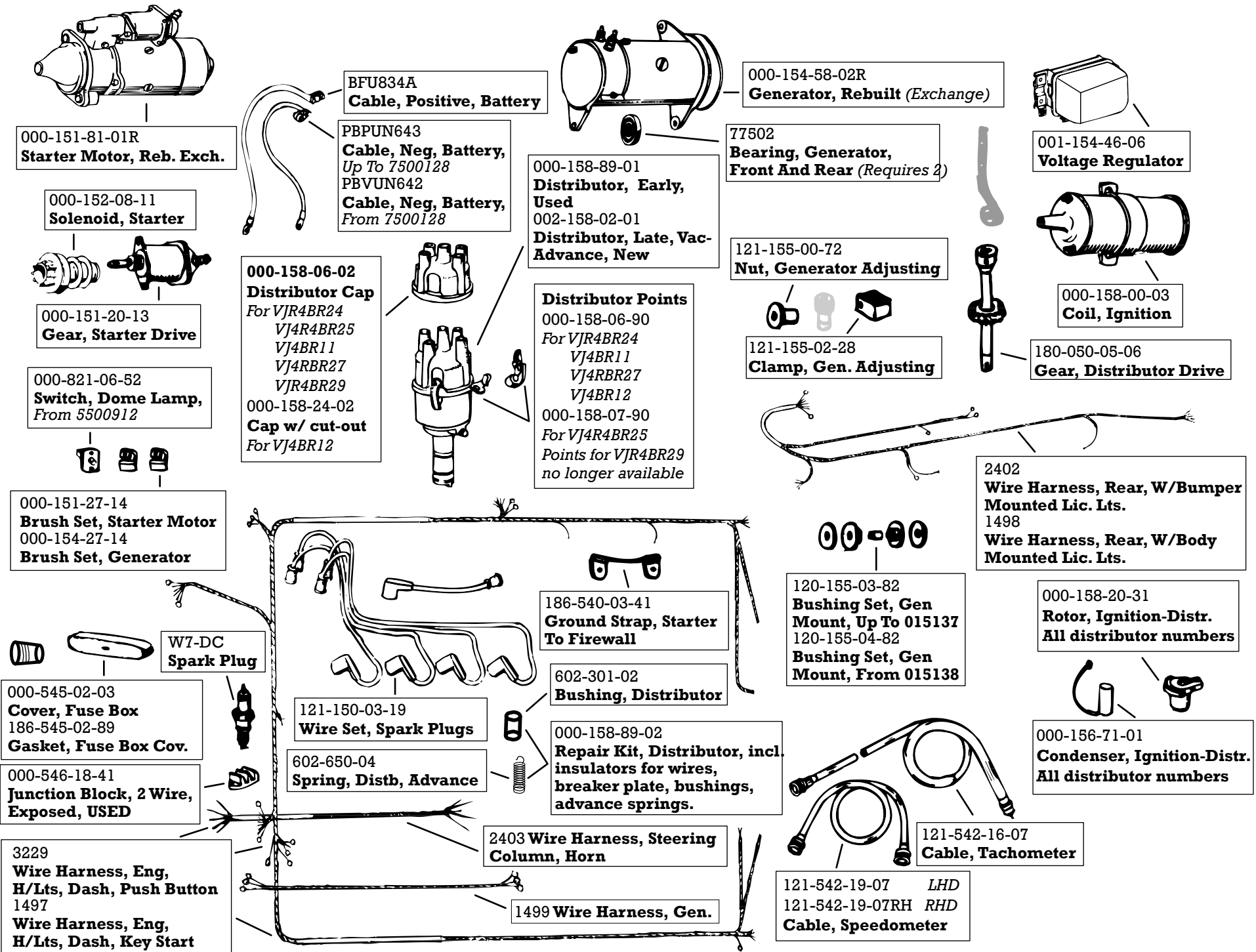




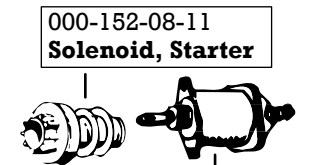






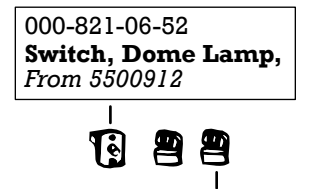


000-151-81-01R
Starter Motor, Reb. Exch.



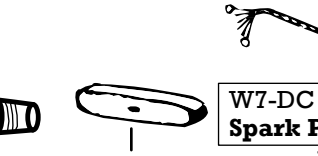
000-152-08-11
Solenoid, Starter

000-151-20-13
Gear, Starter Drive



000-821-06-52
Switch, Dome Lamp, From 5500912

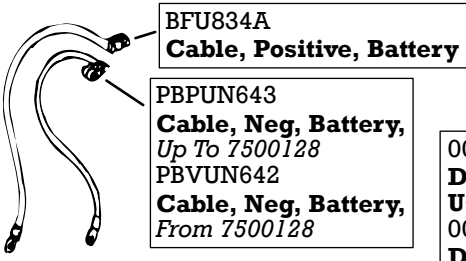
000-151-27-14
Brush Set, Starter Motor
000-154-27-14
Brush Set, Generator



000-545-02-03
Cover, Fuse Box
186-545-02-89
Gasket, Fuse Box Cov.

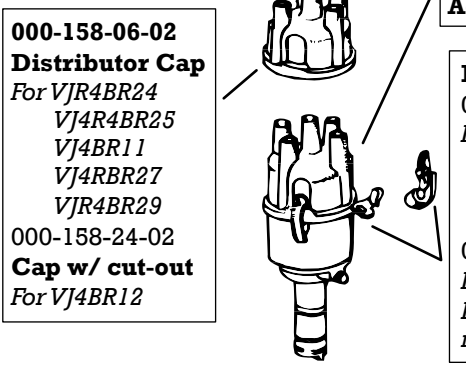
000-546-18-41
Junction Block, 2 Wire, Exposed, USED

3229
Wire Harness, Eng, H/Lts, Dash, Push Button
1497
Wire Harness, Eng, H/Lts, Dash, Key Start



BFU834A
Cable, Positive, Battery

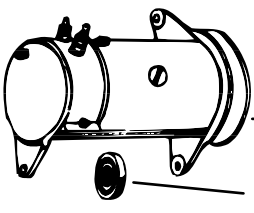
PBPUN643
Cable, Neg, Battery, Up To 7500128
PBVUN642
Cable, Neg, Battery, From 7500128



000-158-06-02
Distributor Cap
For VJR4BR24
VJ4R4BR25
VJ4BR11
VJ4RBR27
VJR4BR29
000-158-24-02
Cap w/ cut-out
For VJ4BR12

000-158-89-01
Distributor, Early, Used
002-158-02-01
Distributor, Late, Vac-Advance, New

Distributor Points
000-158-06-90
For VJR4BR24
VJ4BR11
VJ4RBR27
VJ4BR12
000-158-07-90
For VJ4R4BR25
Points for VJR4BR29 no longer available



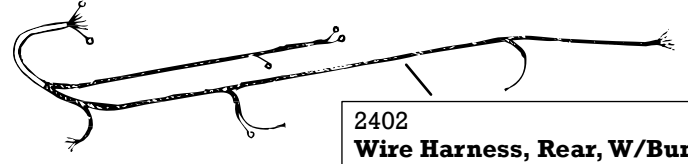
000-154-58-02R
Generator, Rebuilt (Exchange)

77502
Bearing, Generator, Front And Rear (Requires 2)

121-155-00-72
Nut, Generator Adjusting



121-155-02-28
Clamp, Gen. Adjusting



2402
Wire Harness, Rear, W/Bumper Mounted Lic. Lts.
1498
Wire Harness, Rear, W/Body Mounted Lic. Lts.

186-540-03-41
Ground Strap, Starter To Firewall

602-301-02
Bushing, Distributor

000-158-89-02
Repair Kit, Distributor, incl. insulators for wires, breaker plate, bushings, advance springs.

121-150-03-19
Wire Set, Spark Plugs

602-650-04
Spring, Distb, Advance

120-155-03-82
Bushing Set, Gen Mount, Up To 015137
120-155-04-82
Bushing Set, Gen Mount, From 015138

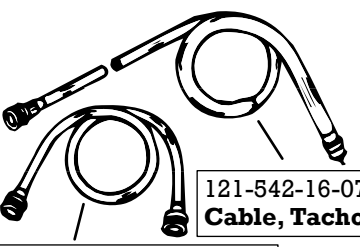
000-158-20-31
Rotor, Ignition-Distr. All distributor numbers



000-156-71-01
Condenser, Ignition-Distr. All distributor numbers

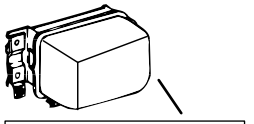
2403
Wire Harness, Steering Column, Horn

1499
Wire Harness, Gen.

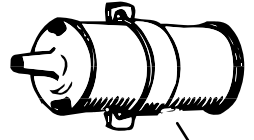


121-542-16-07
Cable, Tachometer

121-542-19-07 LHD
121-542-19-07RH RHD
Cable, Speedometer

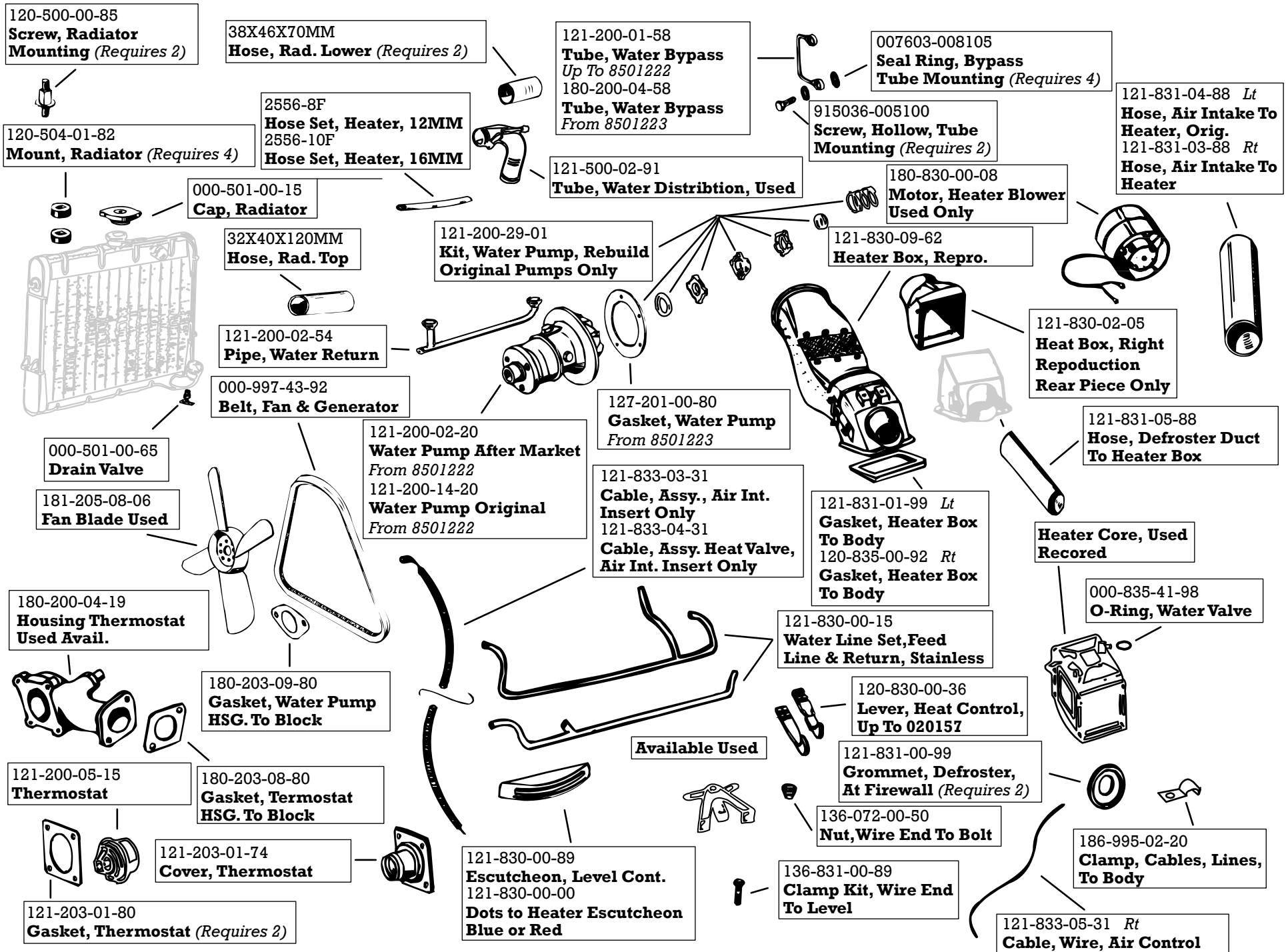


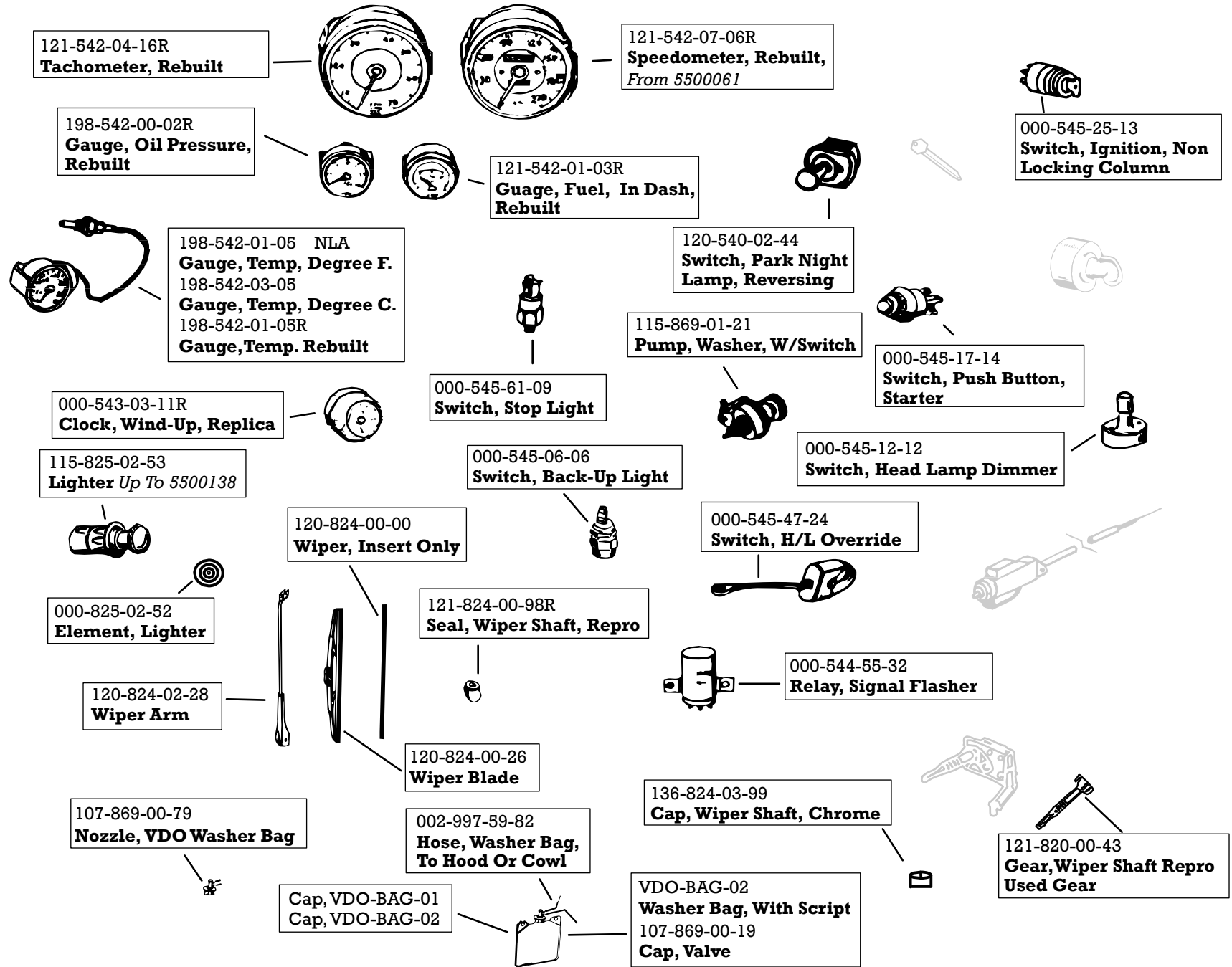
001-154-46-06
Voltage Regulator



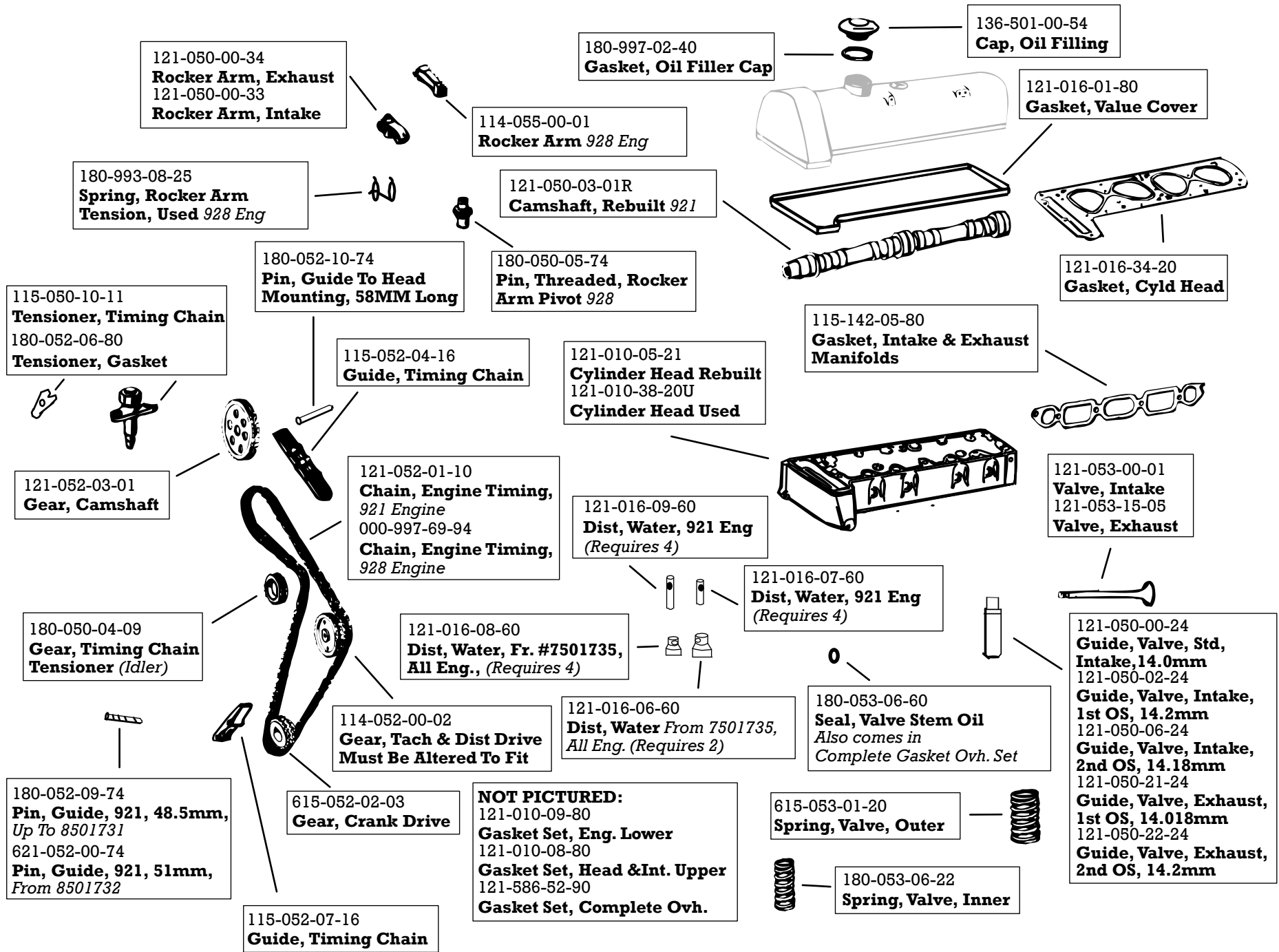
000-158-00-03
Coil, Ignition

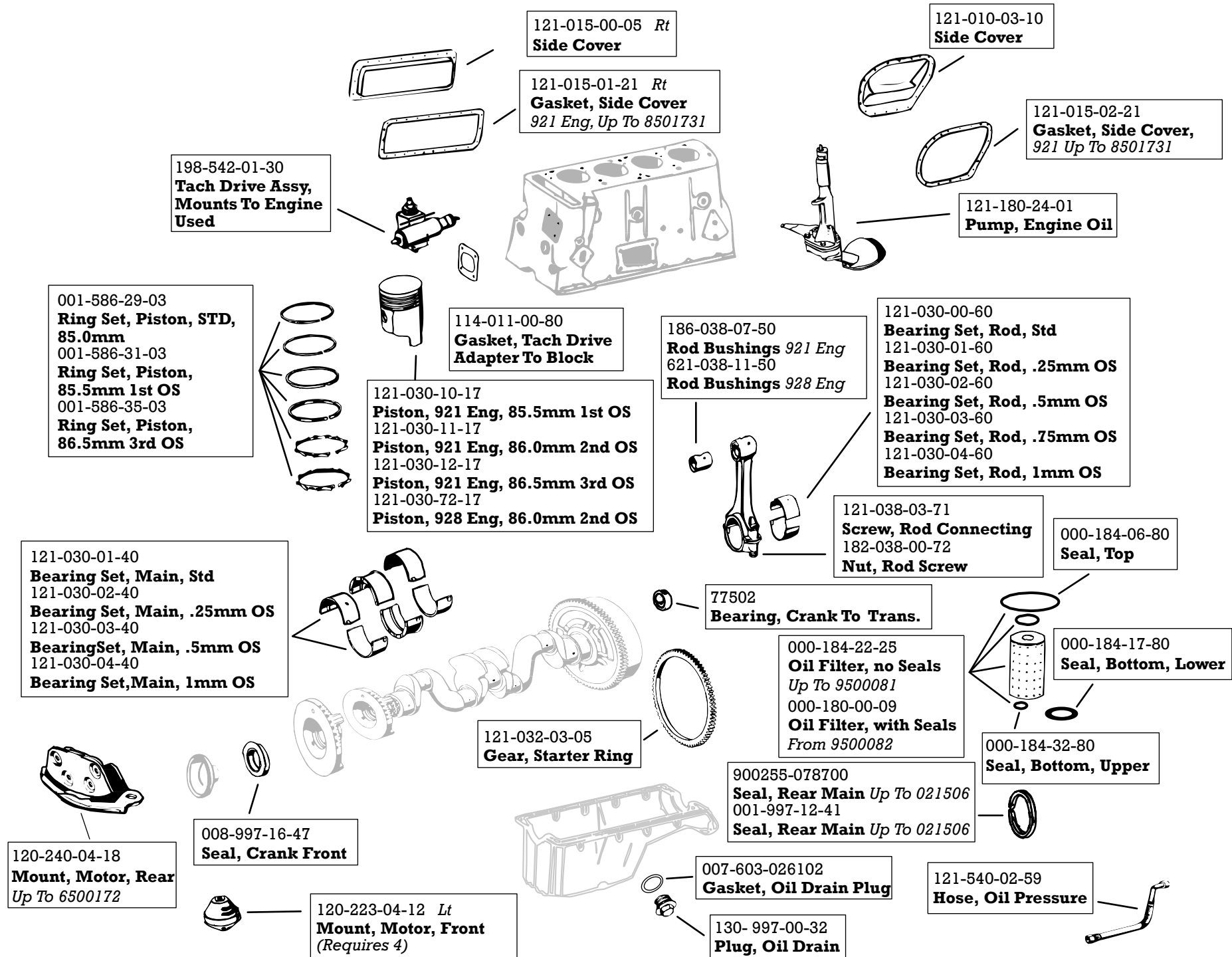
180-050-05-06
Gear, Distributor Drive

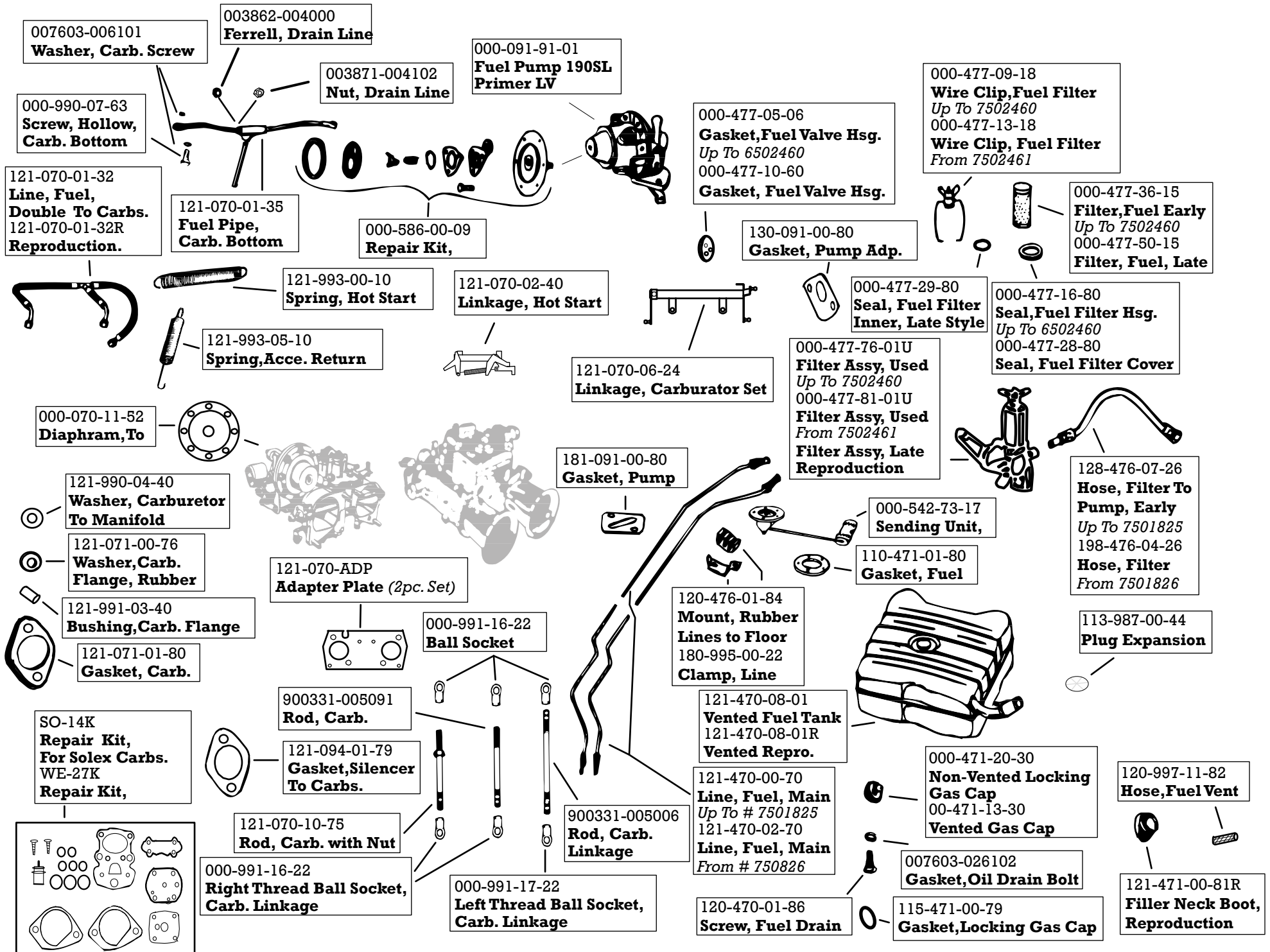




Many Used Parts Available







MANY PARTS AVAILABLE USED

121-880-01-72R *Lt Rear*
Bumper End, Rep. Unplated, Repro.
 121-880-01-72R
Bumper End, Repro, Plated
 121-880-02-72R *Rt*
Bumper End, Rear Repro Unplated.
 121-880-02-72R *Lt*
Bumper End, Rep. Plated
 198-880-04-70R *Rt Front*
Bumper End, Unplt. Plated Bumper End
 198-880-05-70R *Lt Front*
Bumper End, Plated

121-689-00-71
Moulding, Glove Box

121-689-02-72 *Rt*
Moulding, Dash Top

121-689-01-72 *Lt*
Moulding, Dash Top

121-689-02-71 *Rt*
Moulding, Dash Bottom

121-689-01-71 *Lt*
Moulding, Dash Bottom

121-880-06-70RP
Bumper Center, Front, Plated
 121-880-06-70R
Bumper Center, Front Unplated
 121-880-00-73R
Bumper Center, Rear, Repro Plated Rear

121-880-00-23R
Grille Assy, Reproduction

121-885-00-95
Shim, Front Bumper Joints

121-888-00-22R
Grille Frame, Upper Reproduction, Plated

121-888-01-22R
Grille Frame Lower Reproduction, Plated

000-994-02-01
Screw Kit, Grille
 000-994-00-01
Screw Kit, Grille to Body

121-880-01-23R *Lt*
Grille Wing, Repro.

121-880-02-23R
Grille Wing, Rt, Repro.

121-880-03-86
Grille Star & Barrel Assy.

121-750-00-84
Lock Assy Deck Lid, Tab Style

198-885-02-16R *Rt*
Bumperette, Repro.
 198-885-01-16R *Lt*
Bumperette, Repro.

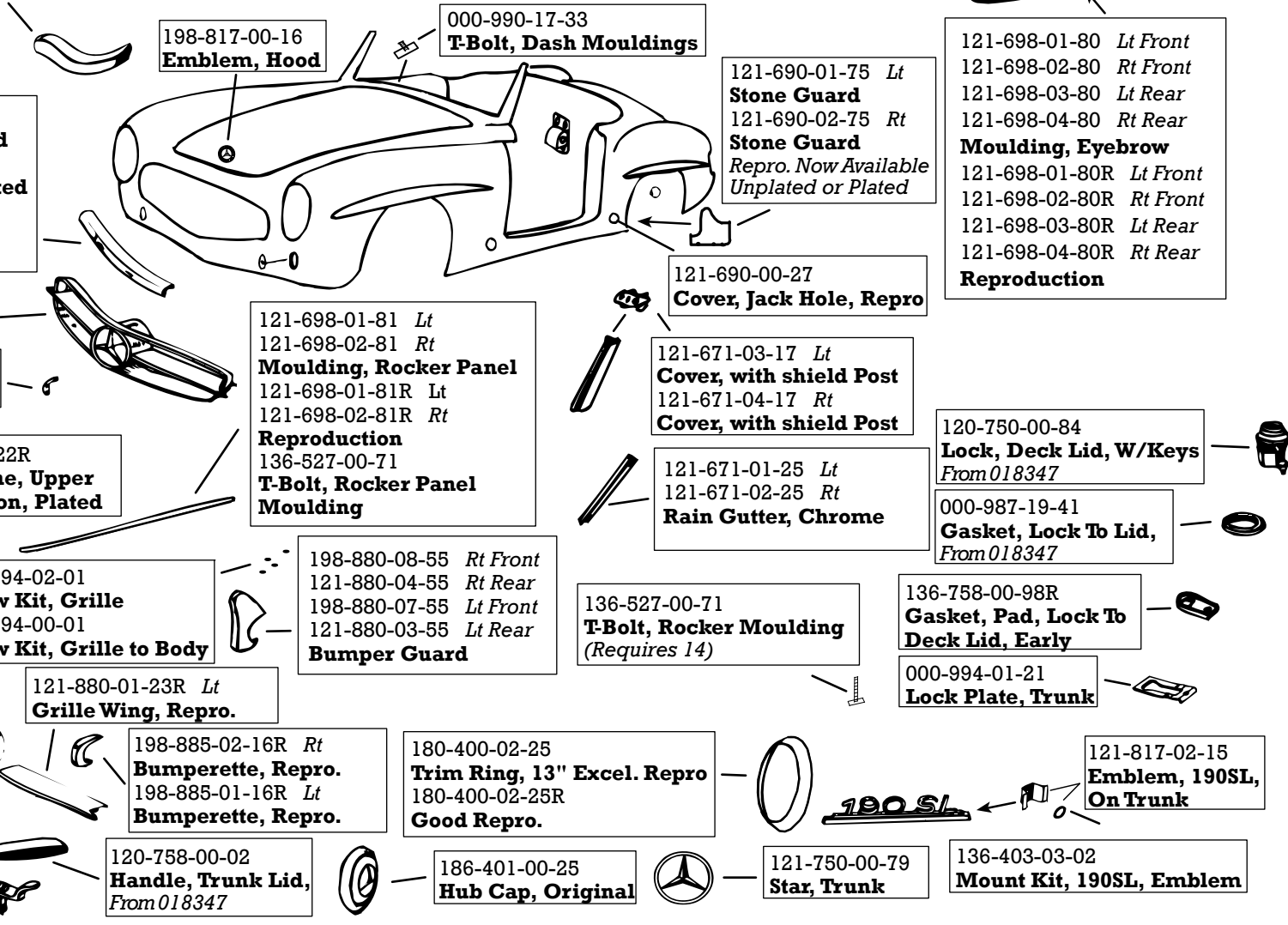
120-758-00-02
Handle, Trunk Lid, From 018347

180-400-02-25
Trim Ring, 13" Excel. Repro
 180-400-02-25R
Good Repro.

186-401-00-25
Hub Cap, Original

121-750-00-79
Star, Trunk

136-403-03-02
Mount Kit, 190SL, Emblem



198-817-00-16
Emblem, Hood

000-990-17-33
T-Bolt, Dash Mouldings

121-690-01-75 *Lt*
Stone Guard
 121-690-02-75 *Rt*
Stone Guard
Repro. Now Available Unplated or Plated

121-698-01-80 *Lt Front*
 121-698-02-80 *Rt Front*
 121-698-03-80 *Lt Rear*
 121-698-04-80 *Rt Rear*
Moulding, Eyebrow
 121-698-01-80R *Lt Front*
 121-698-02-80R *Rt Front*
 121-698-03-80R *Lt Rear*
 121-698-04-80R *Rt Rear*
Reproduction

121-690-00-27
Cover, Jack Hole, Repro

121-671-03-17 *Lt*
Cover, with shield Post
 121-671-04-17 *Rt*
Cover, with shield Post

121-671-01-25 *Lt*
 121-671-02-25 *Rt*
Rain Gutter, Chrome

120-750-00-84
Lock, Deck Lid, W/Keys
From 018347

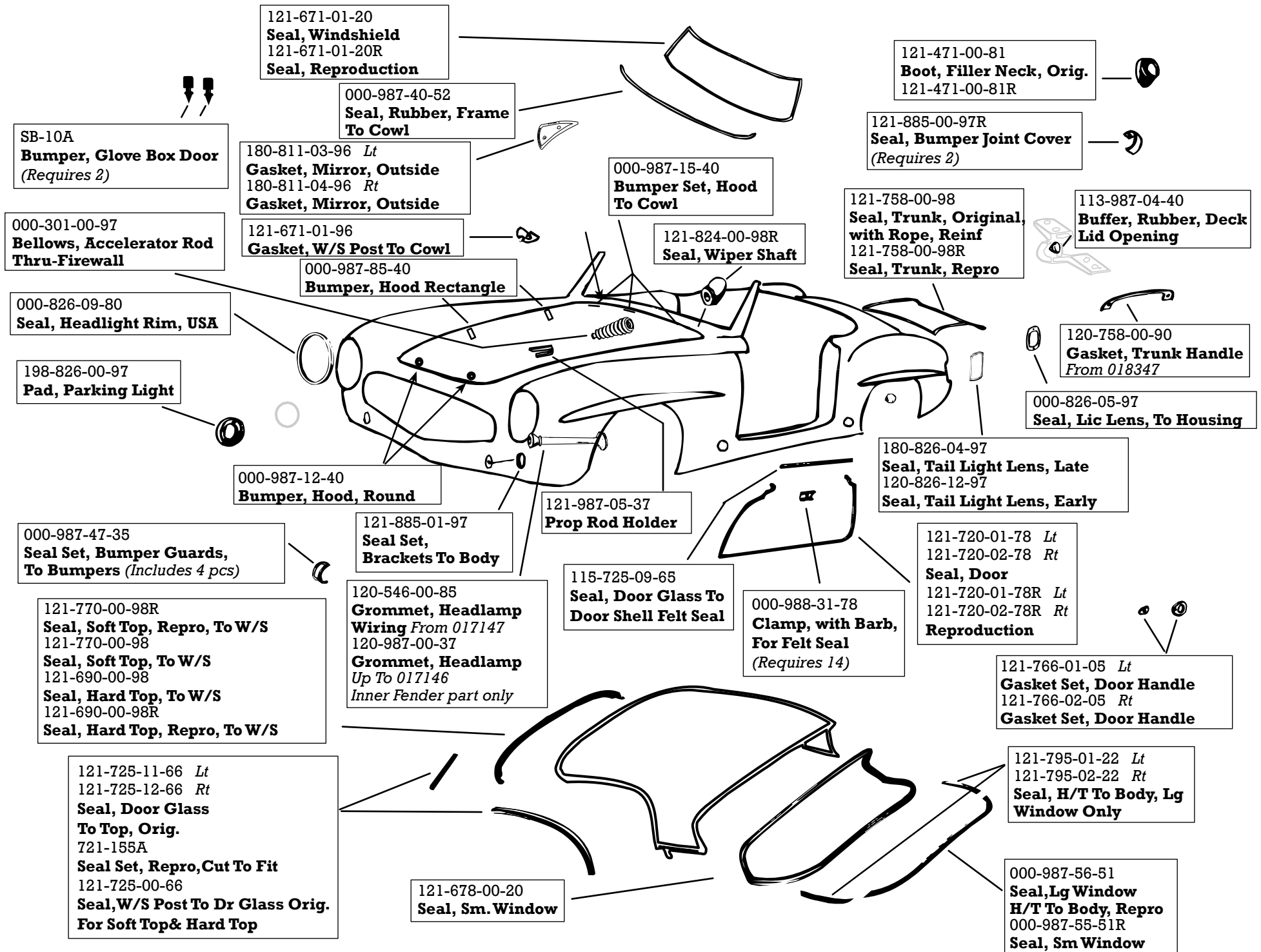
000-987-19-41
Gasket, Lock To Lid,
From 018347

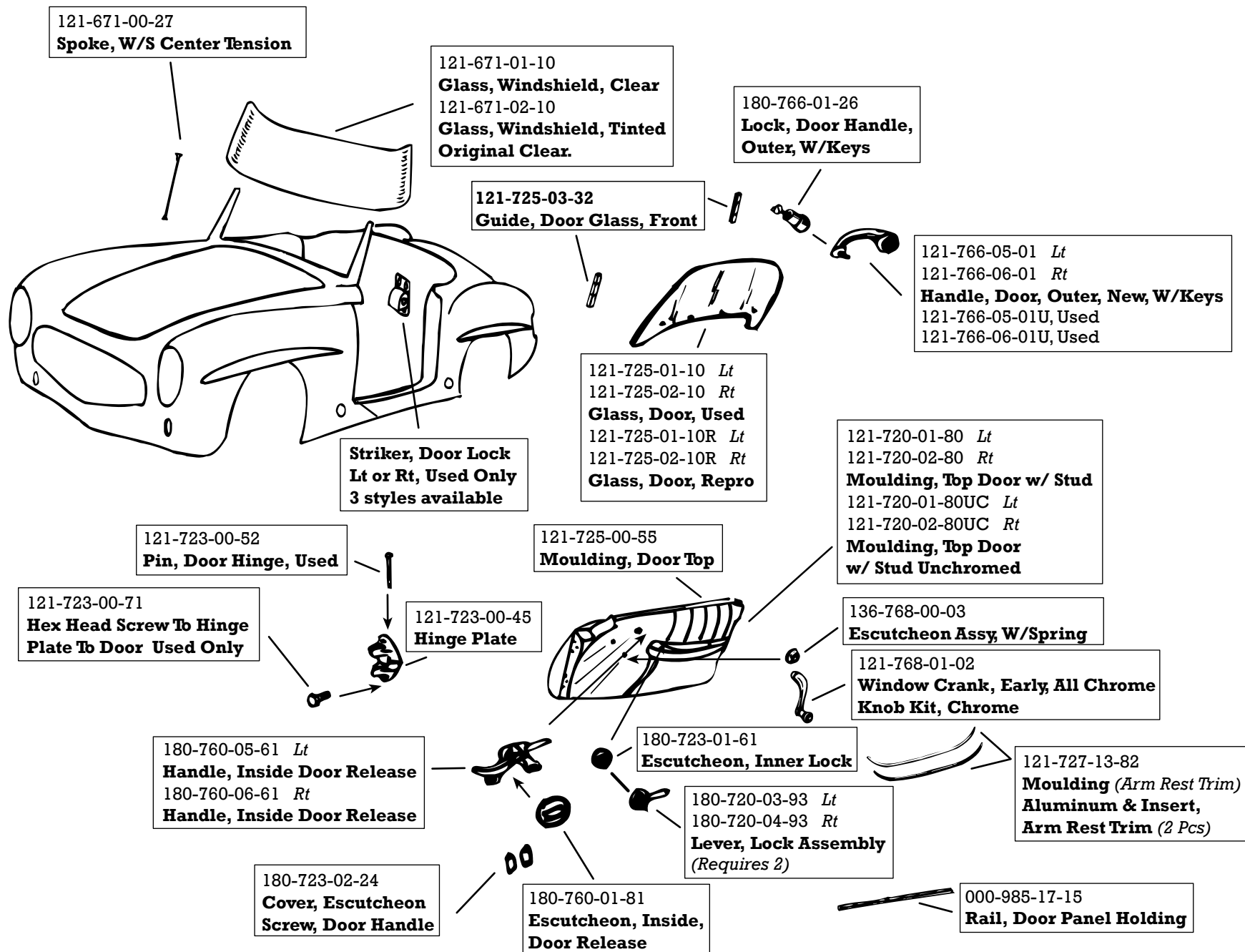
136-527-00-71
T-Bolt, Rocker Moulding
(Requires 14)

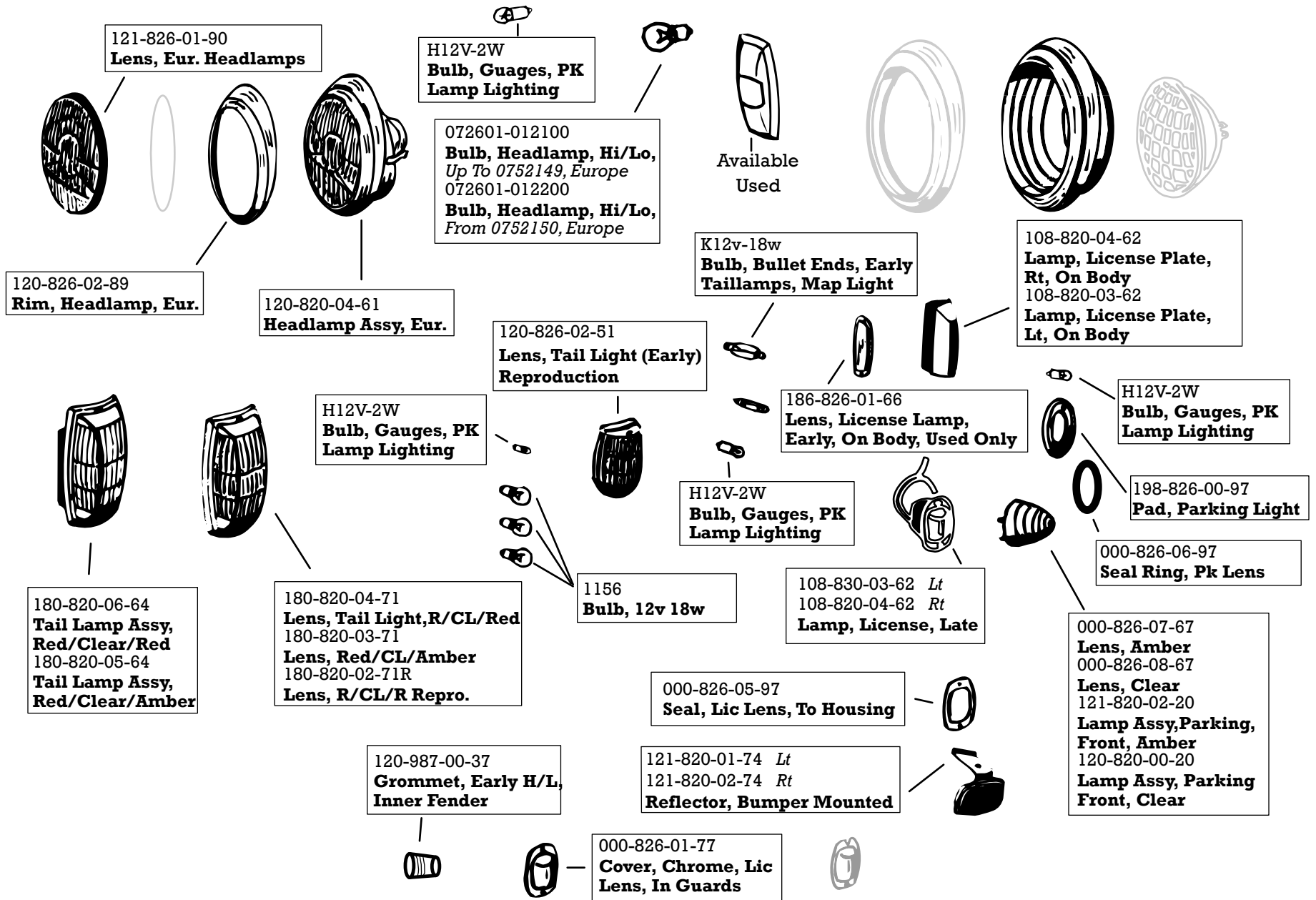
136-758-00-98R
Gasket, Pad, Lock To Deck Lid, Early

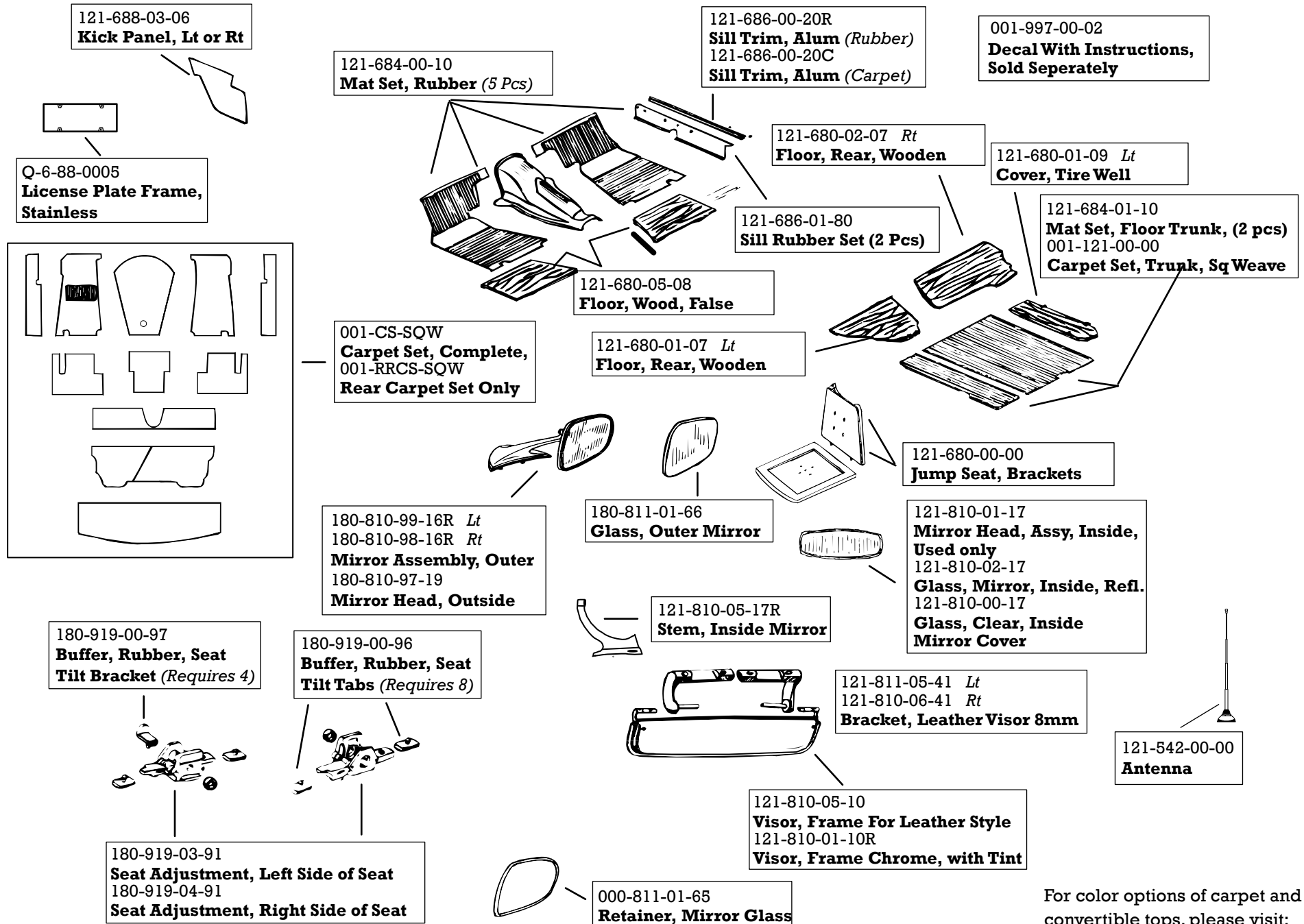
000-994-01-21
Lock Plate, Trunk

121-817-02-15
Emblem, 190SL, On Trunk









For color options of carpet and convertible tops, please visit:
www.kkmfg.com

Leather & Vinyl Interior

- 001-121-FS-LTHR **Seat Covers, Leather Late Style 57-63**
 - 001-121-FS-L-55 **Seat Covers, Leather Bucket Seat Style**
 - 001-121-FS-TEX **Seat Covers MB-TEX late style 57-63**
 - 001-121-FS-T-55 **Seat Covers**
 - 001-121-DP-LTHR **Door Panel Kit**
 - 001-121-DP-TEX **Door Panel Kit**
 - 150-5033-LTHR **Boot**
 - 150-5033-TEX **Boot**
 - 019-LTHR **1 Hide Leather**
 - 019-TEX **1 Yard Vinyl MB TEX**
- Please Specify Color*

121-770-01-65R *Lt*
121-770-02-65R *Rt*
Cable Assembly, with Screw

000-984-50-31
Bolt, Shoulder Top Frame

121-770-00-02U *Used*
121-770-00-02R *Repro*
Top, Frame, Convertible

000-984-51-31
Bolt, Top Frame Hold-Down, Stainless

121-770-09-26 *Lt*
121-770-10-26 *Rt*
Latch Hook Assembly

121-770-00-26
Latch, Top Center To W/S Frame

121-770-05-65 *Lt*
121-770-06-65 *Rt*
Tensioner, S/T

121-779-01-36 *Lt*
121-779-02-36 *Rt*
Cap, End Rail (55-56) Chrome, One Hole
121-779-03-36 *Lt*
121-779-04-36 *Rt*
Cap, End Rail (57-63) Chrome, 3 Hole W/O Snap

121-779-01-29
Rail, Top Cable Hold Down, Aluminum
Also Avail. Used

121-690-01-40
Surround, Large, Aluminum *(Does not come with leather, comes in three pieces)*

121-770-00-66
Cable, Top Tensioner

121-770-01-29 *Lt*
121-770-02-29 *Rt*
Latch, Soft
Used Available

121-779-01-64
Moulding, Soft Top

121-650-01-40 *Lt*
121-650-02-40 *Rt*
Turnbuckle, To H/T, Repro.

121-770-00-37
Wood Bow, Rear Repro.

Footnote
ME-240-G1 *German Blk/Tan*
ME-240-G2 *German Brown/Tan*
ME-240-G3 *German Blu/Tan*
ME-240-G4 *German Tan/Tan*
(Black/Black) Special Order
No Returns On Special Orders

121-720-00-70
Door Panel Board, Wax Board Only

121-770-00-10
Wood Bow, Front, Reproduction

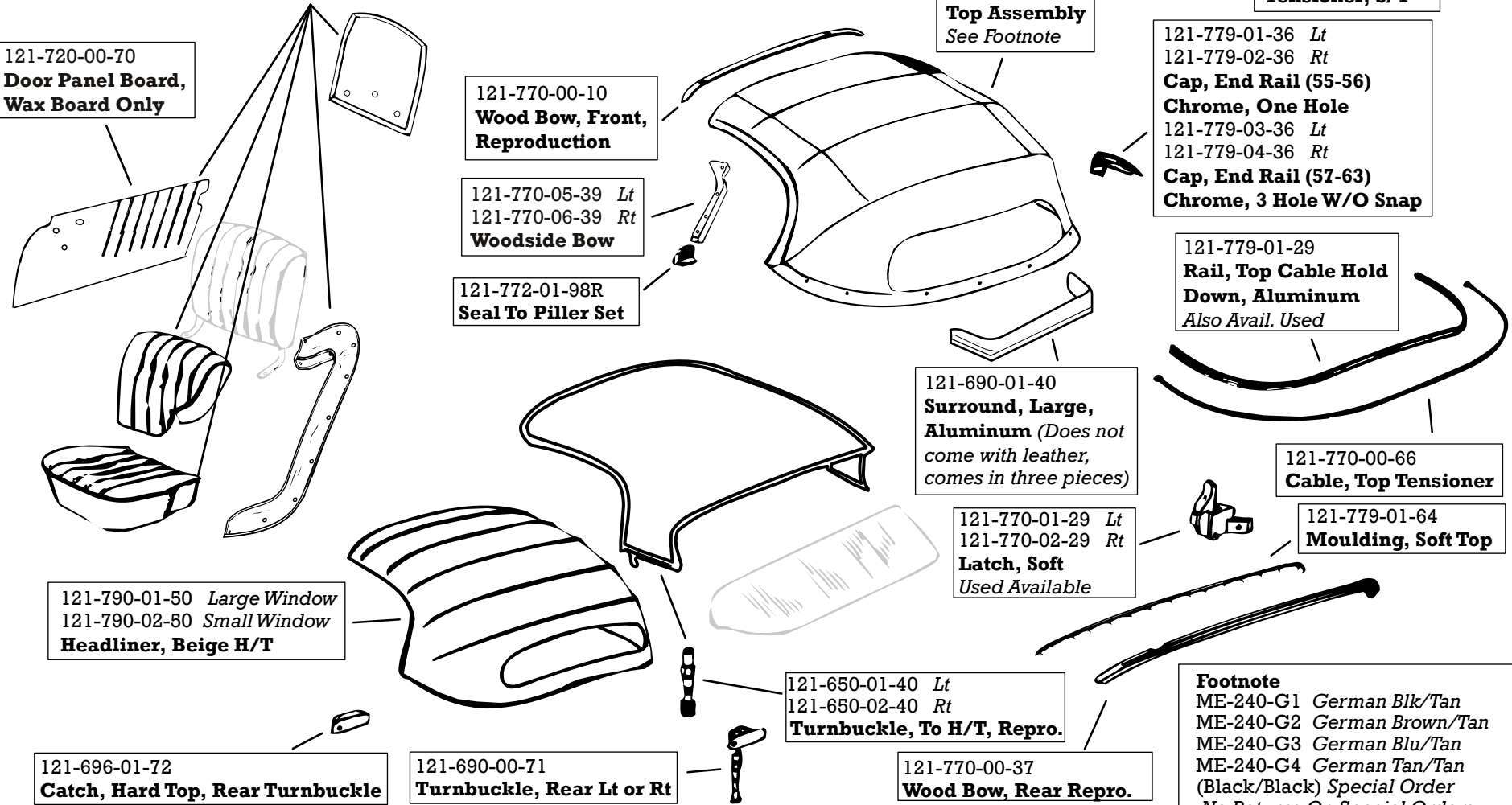
121-770-05-39 *Lt*
121-770-06-39 *Rt*
Woodside Bow

121-772-01-98R
Seal To Pillar Set

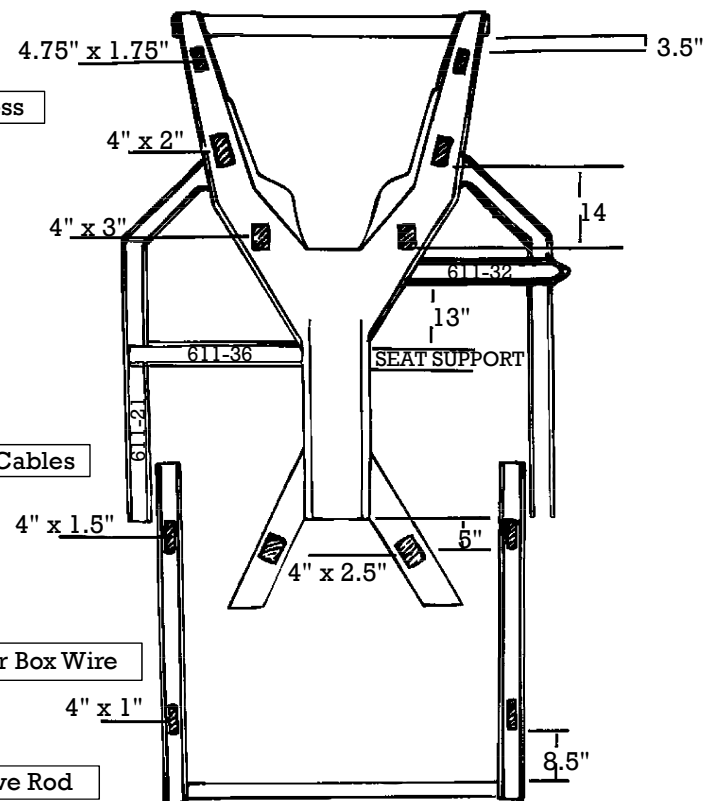
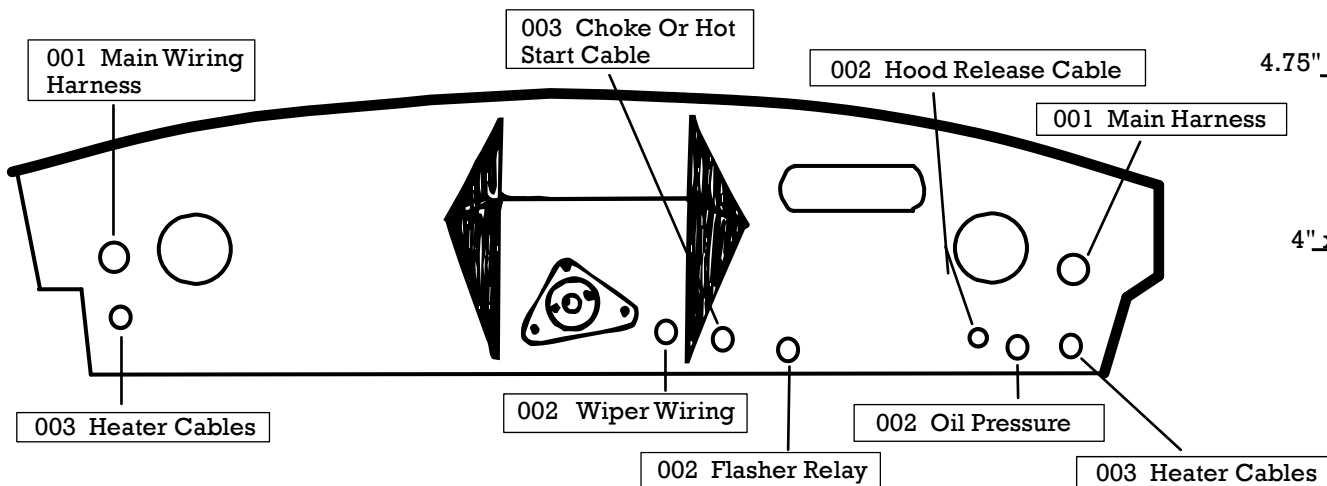
121-790-01-50 *Large Window*
121-790-02-50 *Small Window*
Headliner, Beige H/T

121-696-01-72
Catch, Hard Top, Rear Turnbuckle

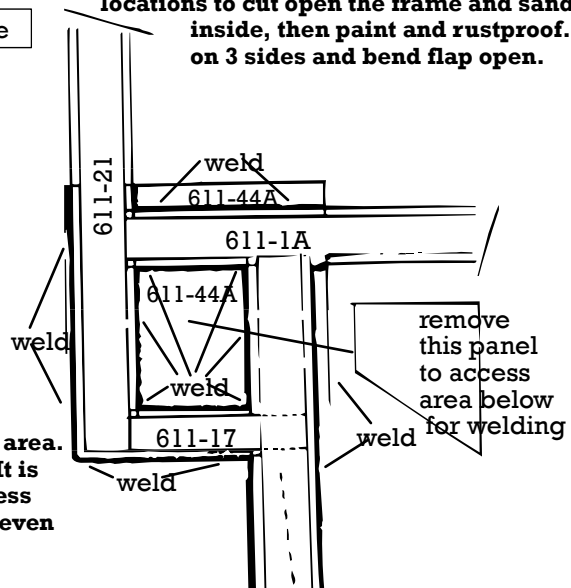
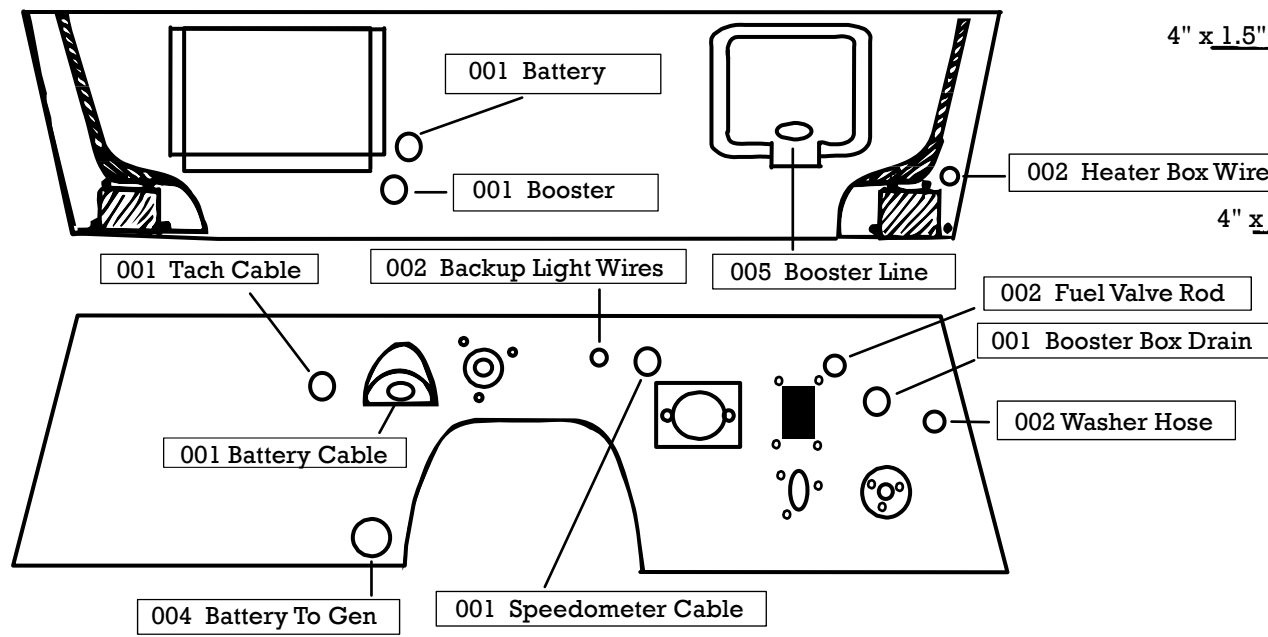
121-690-00-71
Turnbuckle, Rear Lt or Rt



Color samples for leather and tops are available www.kkmfg.com



Above is a layout of a frame for a 190SL. The rectangular shaded areas are suggested locations to cut open the frame and sand blast inside, then paint and rustproof. Cut on 3 sides and bend flap open.



To the right is a sketch of the trailing arm area. Shown are very important areas to weld. It is necessary to remove a small panel to access this area. Sand blast, paint and rustproof even if it appears good from the bottom.

REF #	Q/ VEHC.
001	8
002	8
003	3
004	1
005	1

110-997-88-81
Grommet Set
 Includes all of the above Grommets